

**SCIENCE
CONGRESS
CENTER**

Munich

**INGENUITY MEETS DESIGN,
SCIENCE MEETS BUSINESS**



SCC Munich: New space for new ideas

Ingenuity meets design, science meets business - the new Science Congress Center Munich welcomes event organisers and guests with possibilities well beyond the ordinary. The Garching Research Centre is home to leading research institutes and is also a lively place, full of quality of life. In this environment, the SCC is the ideal launch pad for successful international congresses, conferences, trade fairs and events.

One of the largest naturally lit auditoriums in the world, 14 excellently equipped event rooms of various sizes and 1,600 square metres of foyer space enable conferences with up to 1,300 participants in plenary, exhibitions and trade fairs, as well as concerts, product presentations and events of all kinds. Of course, you can also book the entire SCC Munich, including the exhibition foyers, for your major event.

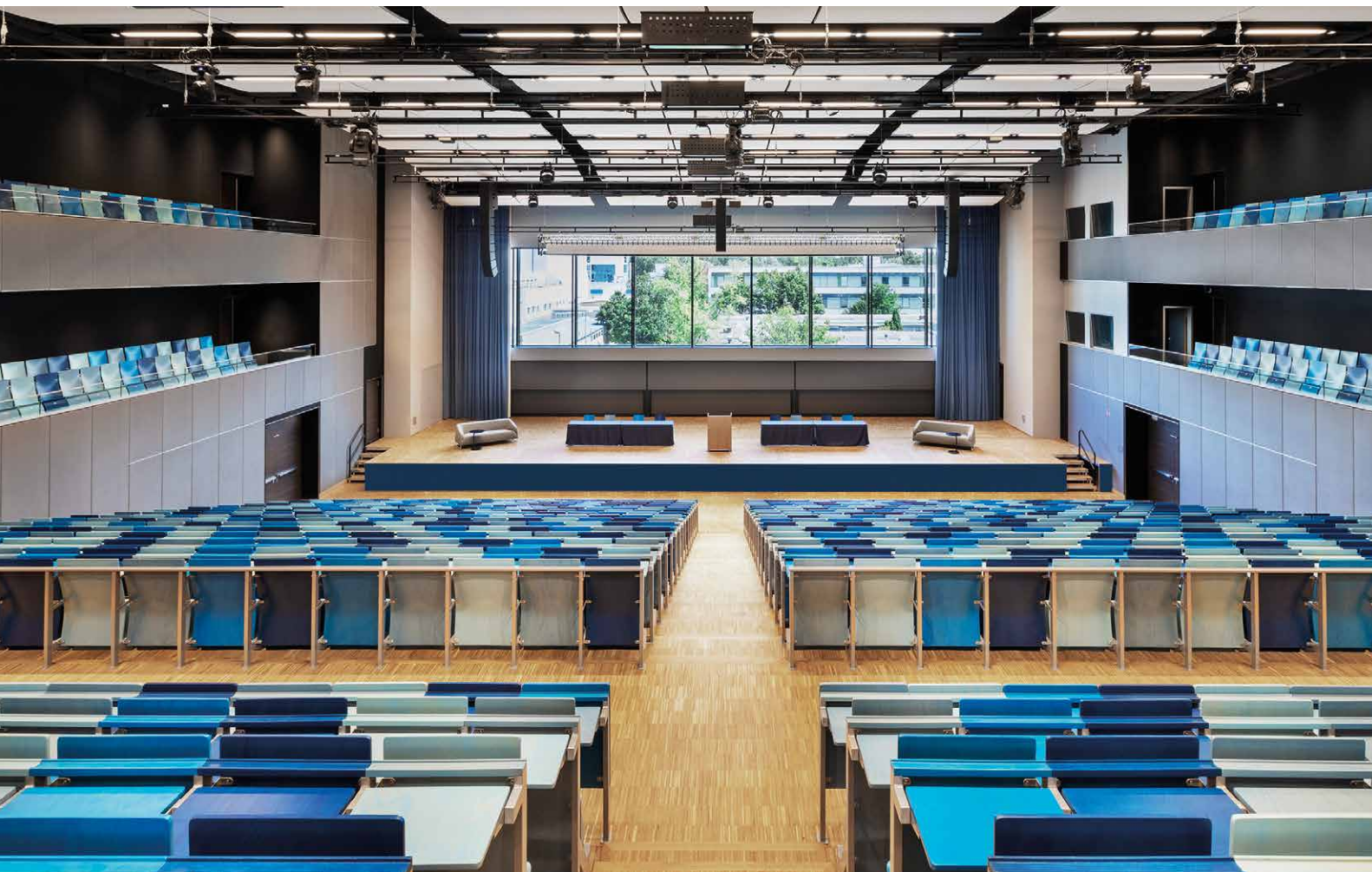

Full-service for complete success

We support you with everything: from custom-equipped conference rooms, to the provision of all required materials and technical aids, as well as accommodation for your guests - all from a single source. Our highly-skilled service and kitchen team provides excellent, creative and healthy food and drinks, including many regional specialities.

Short distances, long on choice

The modern, light-flooded complex of the SCC also houses two hotels - the Courtyard by Marriott Munich Garching and the Stellaris Apartment Hotel, as well as numerous shopping facilities and restaurants - in short: an attractive environment for science to live and thrive in.



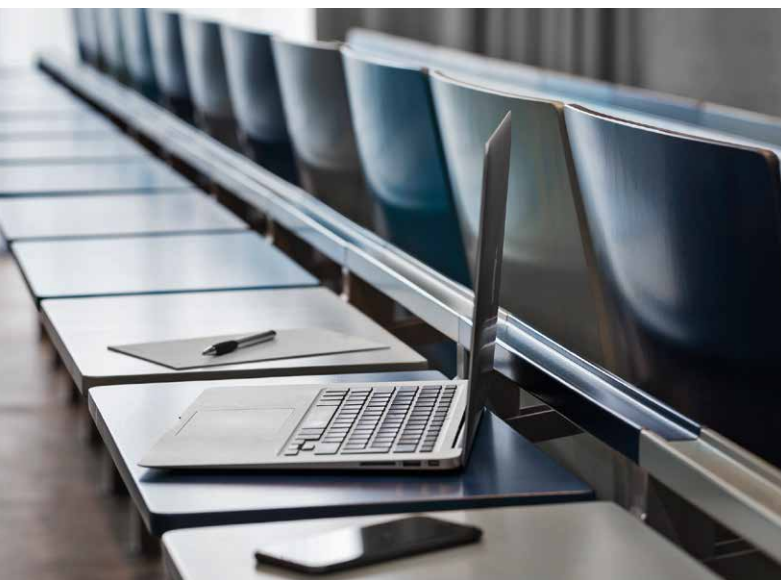

Ground Level

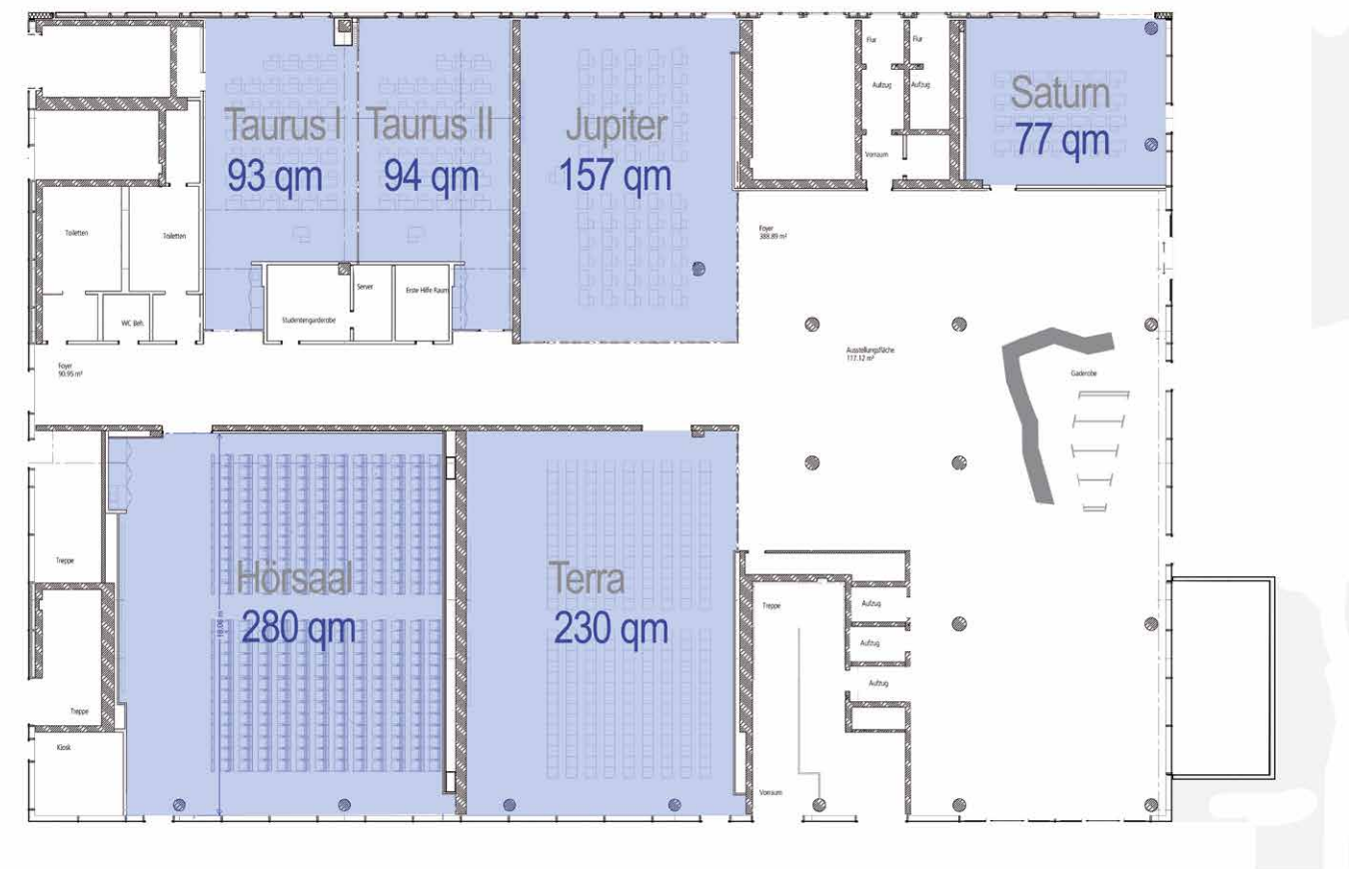

1st Floor

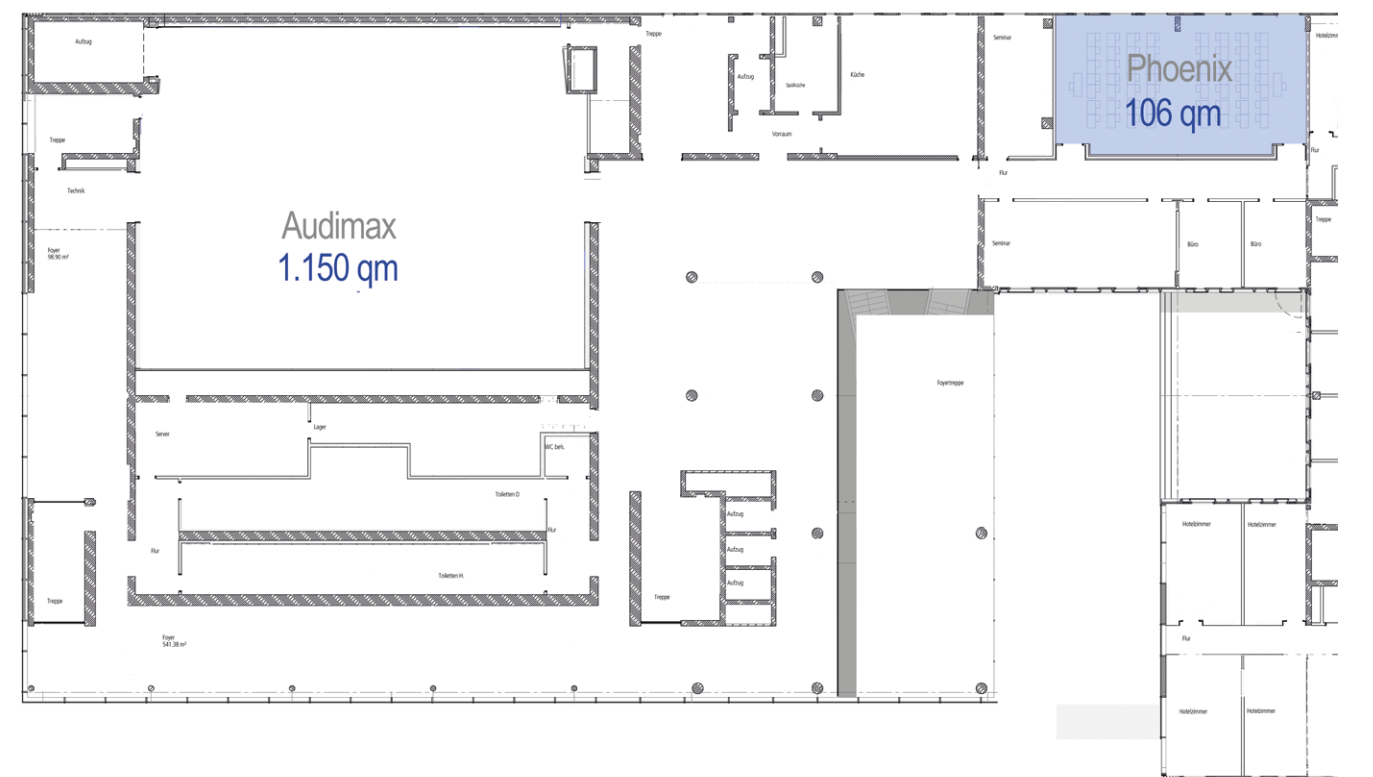

Technical partner of the SSCM

MEDIATEC
Congress & Event GmbH

MEDIATEC Congress & Event GmbH

info@mediatec-muenchen.de

www.mediatec-muenchen.de

T +49 (0)89 3272 939 0





2nd Floor

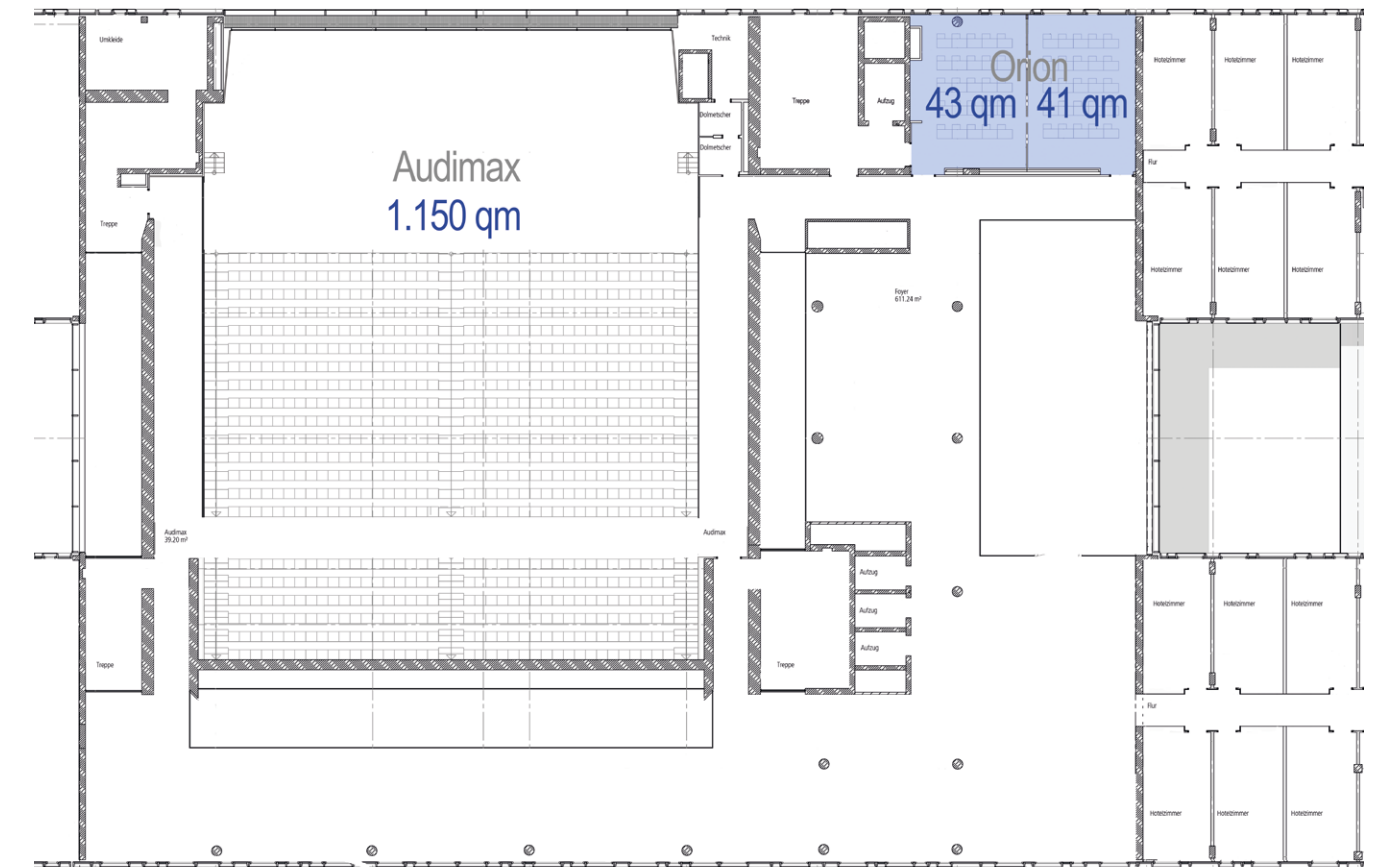

3rd Floor

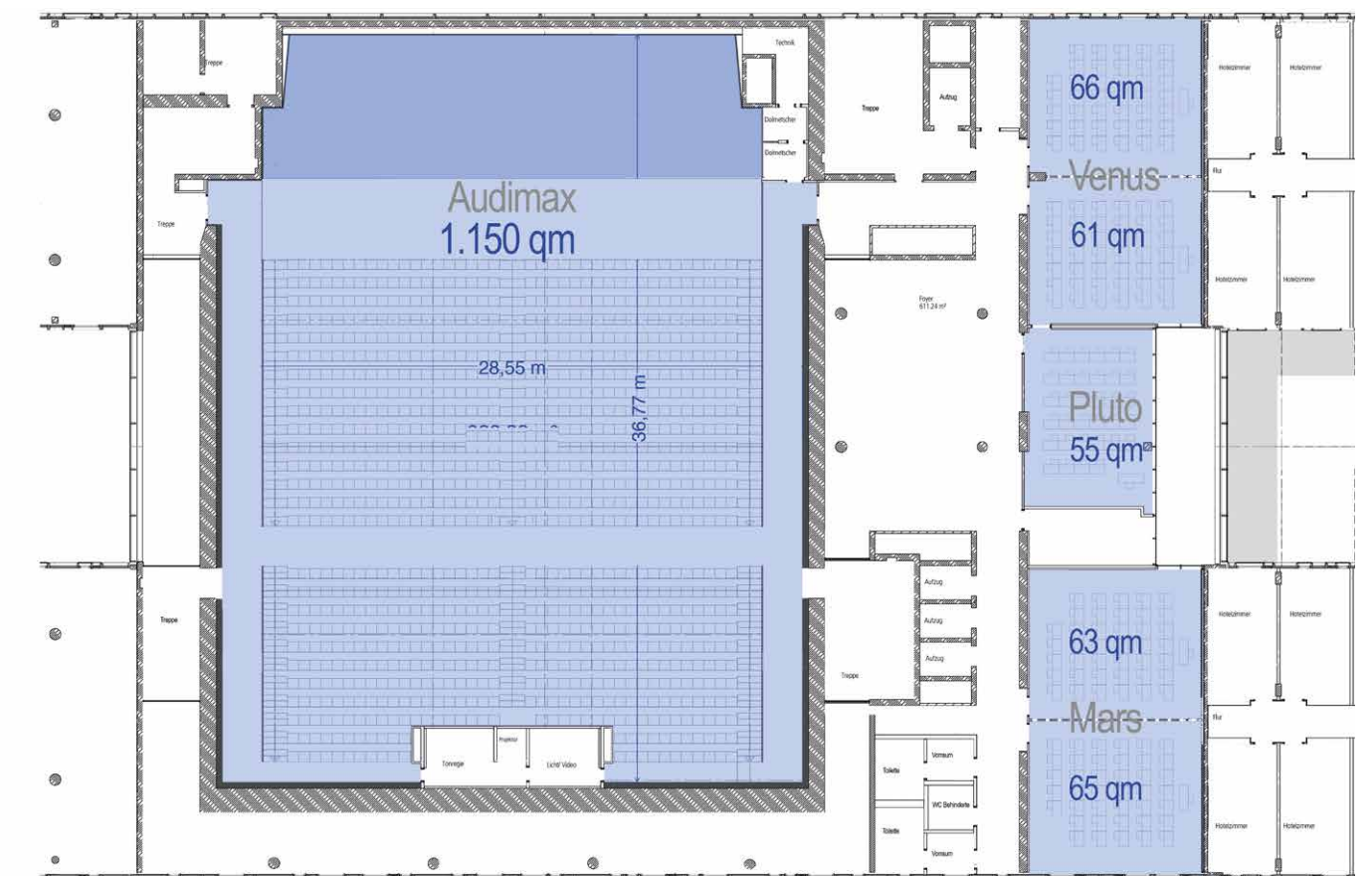



Facts & Figures

- 2,400 sqm (25,800 sq. ft.) of event space
- 1,600 sqm (17,200 sq. ft.) of flexible light-flooded foyer space for trade fairs and exhibitions
- 14 function rooms ranging from 55 to 280 sqm
- Auditorium with 1,300 seats, divisible into several sections for events with up to 570 people
- Freight elevator with direct access to the stage of the auditorium
- Acoustics in the auditorium space suitable for concerts and theatre performances
- State-of-the-art technology and equipment, incl. audio systems and interpreting technology
- Free WIFI
- 550 underground parking spaces
- 2 hotels with 415 rooms, suites and apartments located in the same building complex

Location & Directions

The Science Congress Center Munich is part of the Garching Research Centre of the Technical University of Munich, located about 17 km north of the city centre. Close to the Allianz Arena and the motorway A9, it is very conveniently located halfway between Munich Airport and the Bavarian capital, with the underground line 6 providing a direct connection to the city centre of Munich.

Address

Science Congress Center Munich
Walther-von-Dyck-Str. 10
85748 Garching bei München, Germany
Tel.: +49 (0)89 61425 027
E-Mail: events@scc-munich.com
www.scc-munich.com

Capacity

Name	Floor	sqm / sq. ft.	U-Shape	Schoolroom	Theatre
Audimax	1 st - 3 rd floor	1,150 / 12,378	n/a	n/a	1,300
Lecture Hall	ground level	280 / 3,014	n/a	n/a	300
Taurus 1	ground level	93 / 1,001	32	54	80
Taurus 2	ground level	94 / 1,012	32	54	80
Taurus	ground level	187 / 2,013	44	108	176
Terra	ground level	230 / 2,476	53	144	242
Jupiter	ground level	157 / 1,690	38	87	145
Saturn	ground level	77 / 829	26	42	70
Phoenix	1 st floor	106 / 1,141	38	57	100
Orion 1	2 nd floor	43 / 463	17	18	35
Orion 2	2 nd floor	41 / 441	17	18	35
Orion	2 nd floor	84 / 904	26	45	70
Venus 1	3 rd floor	66 / 710	26	36	55
Venus 2	3 rd floor	61 / 656	26	36	55
Venus	3 rd floor	127 / 1,367	38	72	110
Pluto	3 rd floor	55 / 592	23	30	44
Mars 1	3 rd floor	63 / 678	26	36	55
Mars 2	3 rd floor	65 / 699	26	36	55
Mars	3 rd floor	128 / 1,378	38	72	110
Foyer 0	ground level	388 sqm / 4,176 sq. ft. gross area, 228 sqm / 2,454 sq. ft. net exhibition space			
Foyer 1	1 st floor	640 sqm / 6,889 sq. ft. gross area, 261 sqm / 2,809 sq. ft. net exhibition space			
Foyer 2	2 nd floor	611 sqm / 6,577 sq. ft. gross area, 400 sqm / 4,305 sq. ft. net exhibition space			